

Installation instructions for 3-part Drip Edge, **with no lower skirting** or T molding extending below the floor line.

Note: Mini Drip Edge & cut out near wiper seal is required for this style.

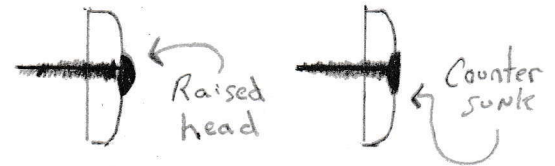
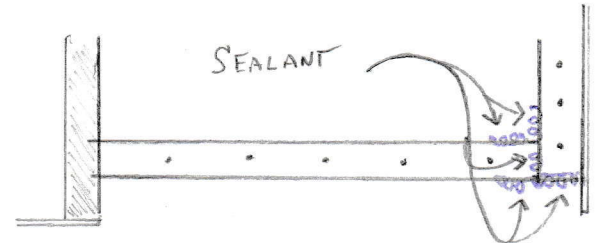
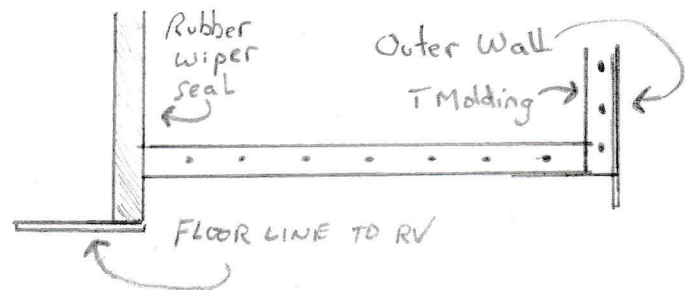

- 1) **Pre-seal** as needed w/ quality clear sealant around any voids (cracks/ spaces) in the area: including end portions of the lower molding strip, & spaces around & under the outer corner floor area. **Do not use a silicone product! As other tapes & sealants will not stick to silicone.** Any previous silicone that was used in the areas working on would need to be fully removed.

2) Install Mini Drip Edge

(Note): If any screw heads are in the way, it's best to remove & replace with a flat head, counter sunk style, which will eliminate most of the height of the screw head sticking outward. Apply sealant in first before putting new screw in place

- a) Use supplied template; to determine where this can be attached, to extend down past the outer floor area. Hold up to the lower determined area to see if it clears the slide room floor opening. You only need about 3/8" area to attach this to the side wall. You can normally get this even if placed right below a screw head. You can make your own template if needed to make adjustments w/ card stock provided. Trim & test your template and make any adjustments if needed. Note: you will want a 1/8" gap from the bottom of the Mini Drip Edge to the floor opening.

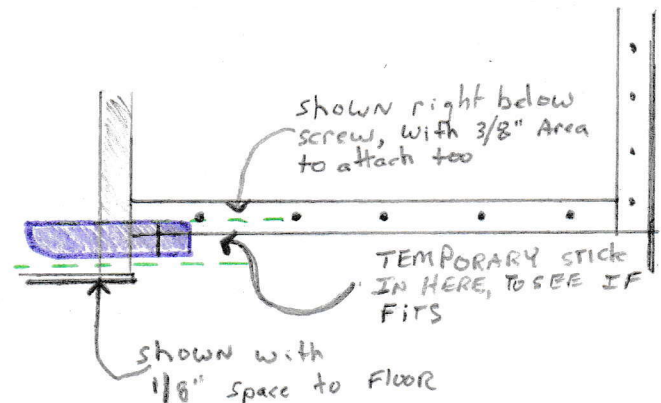

- b) Trace cut out template on supplied vinyl & cut out 2, (1 per side). Note: you may have extra vinyl, as each 40" section comes with enough to do two for shorter depth slide rooms. Do one opposite (mirror image) for one, so both have the textured side showing forward. Sand edges smooth as needed. Fold Mini Drip Edge like shown on template provided. Only needs 3/4-1" fold over area. Do not bend more than needed while folding. Note: One will be folded in opposite direction for the other (mirror image) side.

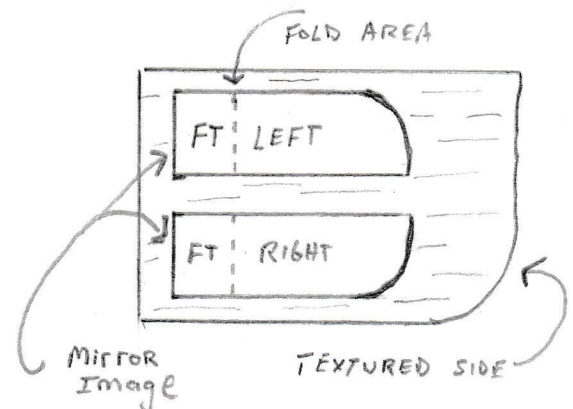

- c) Prep back (shiny side) of your Mini Drip Edges, by lightly sanding the top section, where your 2 sided tape will be placed. Clean w/ rubbing alcohol & let dry. Attach 2-sided tape to shiny side across top edge where sanded, pull off backing after in place.

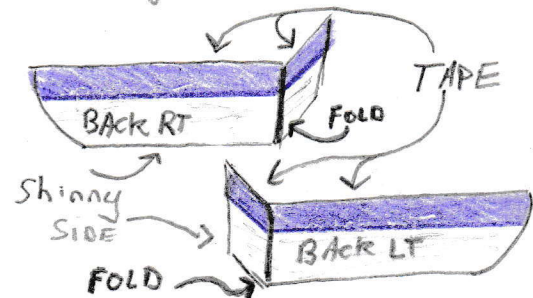

- d) Wipe down area Mini Drip Edge will be placed (outer corner) w/ rubbing alcohol, let dry. Tightly push (both sides) of Mini Drip Edge in place, so its firmly attached to the outer bottom corner / floor edge were marked off so, it clears the floor line (when retracted) & outer wall T molding. Once attached, use the same clear sealant around the top & sides of the Mini Drip Edge. Smooth w/ finger & let dry before next step.

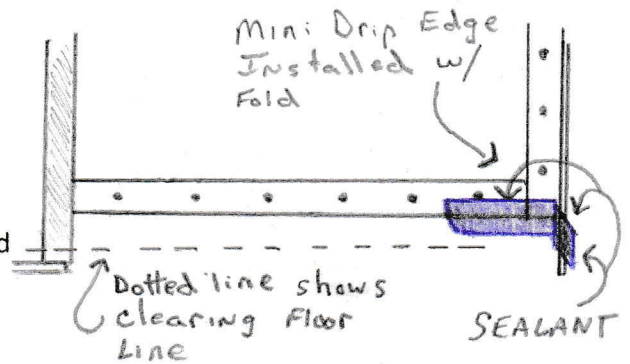

- 3) **Trim Drip Edge sections** to the correct length needed. The top (Smaller fixed section) will start pushed up against the wiper flap, & go right up to the edge of the opposite end (T molding). The larger removable section will be proximately $7/8$ " longer, as the extended section will go in past the wiper seal towards RV.

- 4) **Install smaller fixed permanent section of Drip Edge.**

Note: If any screw heads are in the way, its best to remove & replace with a flat head, counter sunk style, which will eliminate most of the height of the screw head sticking outward. Apply sealant first before putting new screw in place.

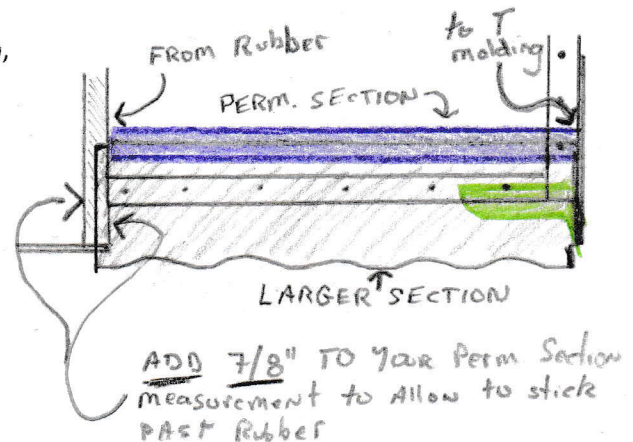

- a) Attach both sections together via hook & loop, with the smaller on the top and larger on the bottom. Hold up against side wall of slide room to **determine** best mounting locations & drop. Use level & mark off across top with few sections of painter's tape to use as your installation guide for the next step. The goal is to have the larger section hang down **past** the Mini Drip Edge. If your RV has a lower molding strip that's above the Floor, you would want to mount this above that strip by approx. 1" inch. The bottom of this permanent section can be as low as the bottom of the slide floor. You don't want it sticking down past the slide room floor. "For cable drawn slide rooms; this may be common to mount the fixed portion very close to the bottom of the floor in order to clear the mounted cable hardware.

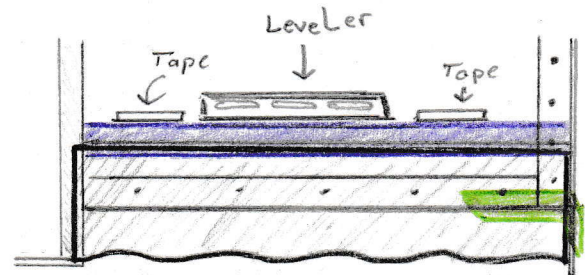

- b) Clean off area below the taped line where the fixed section will be attached to w/ rubbing alcohol & let dry. Separate the two parts, keeping the smaller section, pull backing off the VHB tape a little at a time, start attaching right up against the rubber wiper seal, and work your way down slowly towards the T molding, following your straight painters tape line. Push down w/ pressure & rub down along all the top Portions of the permanent section that's just installed. Remove painters' tape that's above.

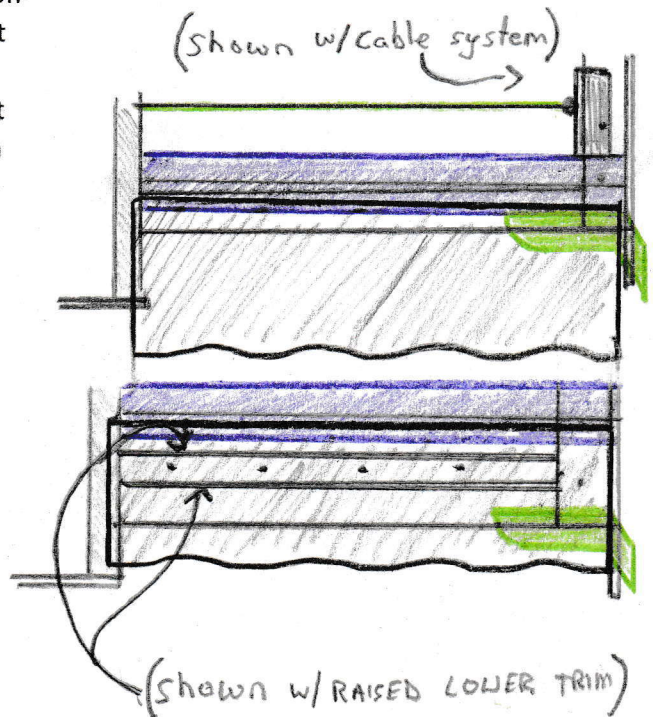

- c) You will most likely have a small bridge gap to fill that would be the transition from the T molding trim & the side wall. Use the supplied butyl tape, by pushing in to fill all visible portions of gap, then smooth over, trimming off any extra.

- d) Use same clear sealant again (not silicone), apply a small bead all the way across top ledge of mounted section, smooth over forming an angled/ curved ledge. Note: You can put down painter's tape spaced approx. $3/16^{\text{th}}$ inch above the permanent section before applying sealant to give you a clean caulk line. Simply apply tape, then sealant & run your finger down to smooth, and then immediately (slowly) pull the painters tape backup. (You don't want a skin to form before pulling up). Allow sealant to fully dry.

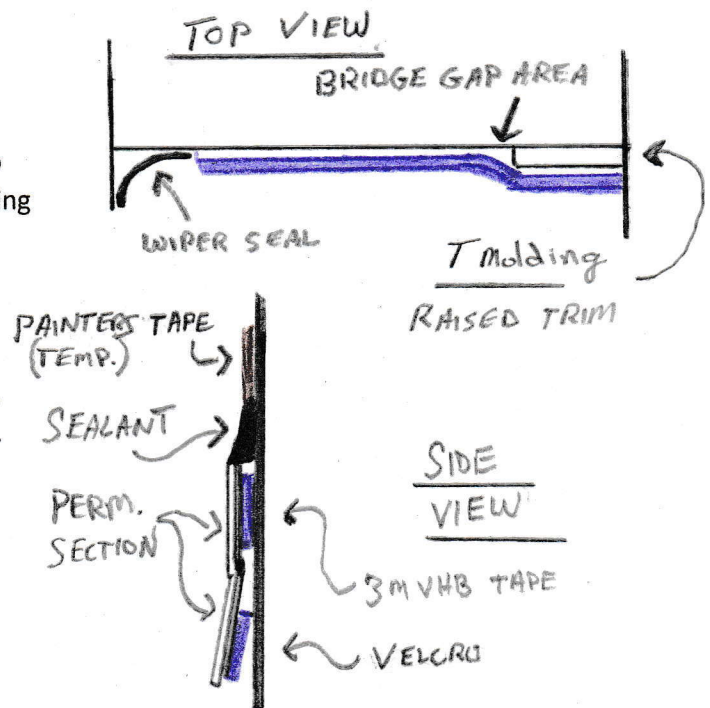

- 5) **Trim rubber wiper side of Drip Edge** (larger removable section); this will allow your Drip Edge to go past(behind) the rubber wiper seal. A small angled cut out is needed to allow this to happen.

- a) Take half sheet card stock paper (line side facing towards you), push up behind the Velcro that's attached to the permanent section, so it's just barely past the $1/2''$ drawn line. Both the $1/2''$ drawn line and permanent sections should be even & parallel with each other. While holding up in place, mark off $1/8''$ above the floor line onto the cardstock paper.

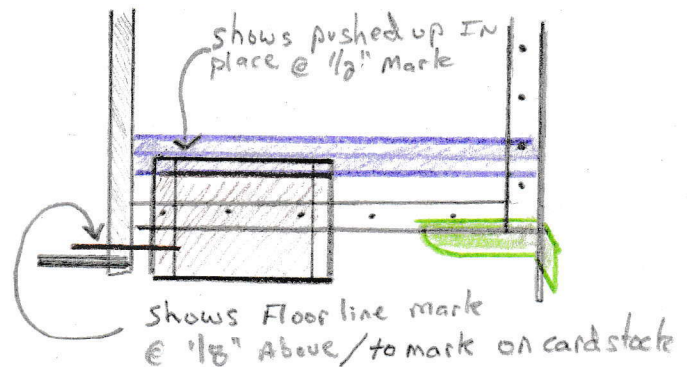

- b) Now that you have the floor line mark on the cardstock, draw a straight line (horizontally) to meet the pre-drawn (vertical) $7/8''$ line. Draw an angle (as pictured) to connect the two lines together.

CARD STOCK w/ $1/2''$ & $7/8''$ LINES

- c) Cut out the drawn in angle. This is now your template used to trace onto the larger section of the Drip Edge. Test your template & make any adjustments if needed. **Note: You will need to make a template for each side, as the opposite side could be mounted at a slightly different height.**

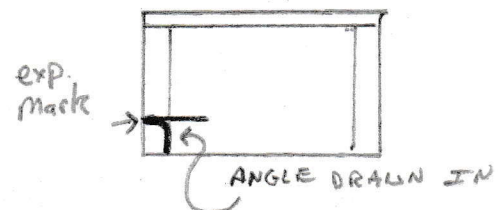

- d) Place template directly over the end of the larger section, and trace the small notch onto the Drip Edge, then cut out this section. **Note: you will not end up with the same ends cut if doing both sides; one will be cut out on the right side & the other on the left side.**

LARGER SECTION ↓



Cut out template over Larger Section - to mark & cut out small notch

NOTE: Above shows for LEFT SIDE, RIGHT SIDE would be on opposite end.

- 6) **Line up & install the larger section** of the Drip edge into the smaller permanent section via hook & loop (Velcro). Start with the notched side going into the wiper seal area & work way down towards the T molding, pushing it up in place. Take your time lining it up the first time, as you can't remove & reposition this section for the first 72 hours, this is the amount of time needed for the VHB tape to bond properly that's in the smaller permanent section. Pulling on this too soon could result in the permanent section to become loose or sealant applied to top to shift.

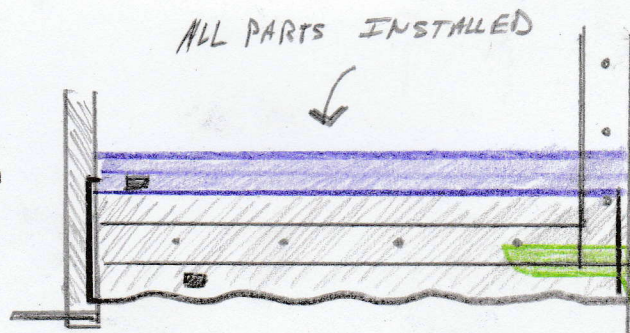

- 7) Draw a small chart on paper & number the back sides of the Drip Edge part (with black permanent marker), so you know what slides & what sides they go on, for making future Placements simple. **Remember to remove the larger portion of the Drip Edge before bringing In your slides!!!** The smaller permanent section & Mini Drip Edge sections both stay on. To remove the larger section, simply start with either side, and pull forward towards you a little bit at a time, working your way down. It will separate and tear off nicely. The product will flex while doing this, which is normal.

Installed
Diagram

