

Installation instructions for slides with no lower skirting or T molding extended below the floor line.

Note: Mini Drip Edge & cut out near rubber seal is required for this style.

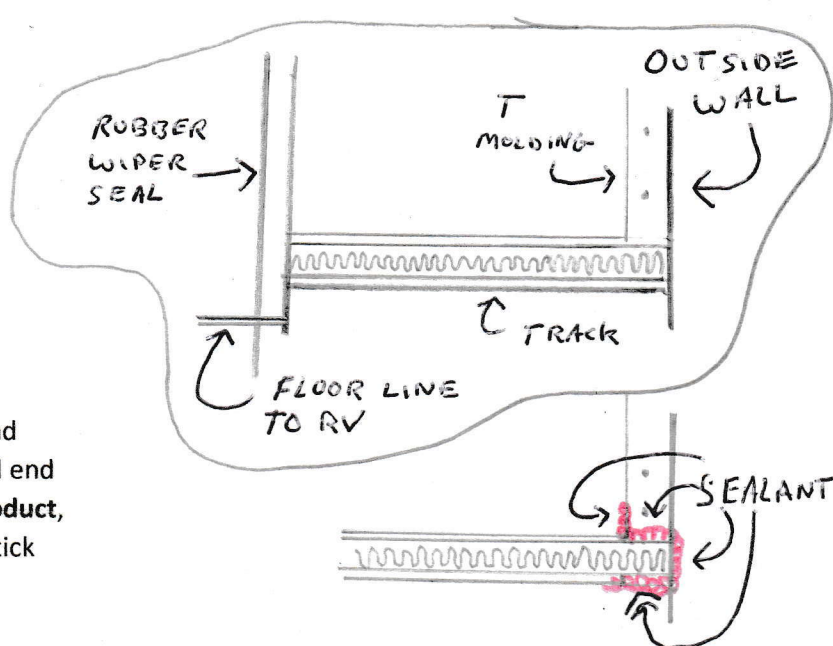

- 1) Pre-seal as needed w/ quality clear sealant around any voids (cracks/spaces) in the area, and around end of track and T molding. **Do not use a silicone product**, as the two sided tape or other sealants will not stick to silicone! Smooth flat w/ finger.

2) Install Mini Drip Edge

- a) Use supplied (pre-cut) template, hold up to lower track to confirm it clears the slide room floor opening, you can make your own template if needed for your application.

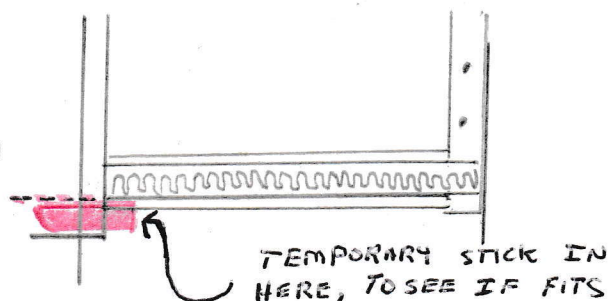

- b) Trace onto supplied vinyl & cut out 2, (1 per side), do an opposite (mirror image) for one, so both have the textured side showing forward. Sand smooth as needed. fold Mini Drip Edge, as shown on template, Do Not bend more than needed while folding. One will need to fold in opposite direction for the other side.

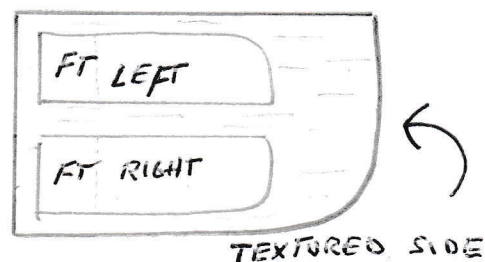

- c) Prep-back (shiny side) of your 2 Mini Drip Edges, by lightly sanding the top section, where your 2 sided tape will be placed. Clean w/ rubbing alcohol & let dry. Attach 2 sided tape to shiny side across top edge where sanded. Pull off tape backing when done, & set aside.

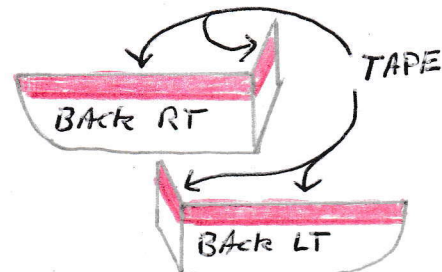

- d) Wipe down area Mini Drip Edge will be placed (outer corner) w/ rubbing alcohol, let dry. Tightly push (both sides) of Mini Drip Edge in place, so its firmly attached to the lower track & the outer wall T molding. Once attached, use the same clear sealant to seal around the Mini Drip Edge, smooth flat with finger & let sealant dry before next step.

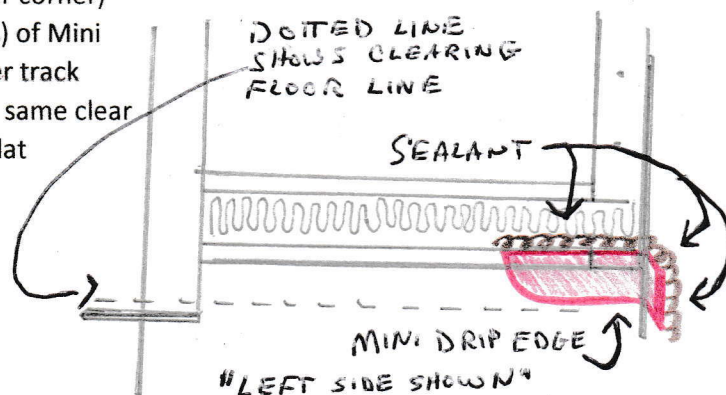

- 3) Determine the correct length of your main Drip Edge & trim as needed. Measure complete opening the product is to cover & add an additional $\frac{7}{8}$ inch of material to stick in past rubber seal. You can always leave a little extra on & trim off towards the Mini Drip Edge side afterwards. TIP: Using the back side of the Velcro tape strip (paper backing), this can be used as a more flexible measuring device to get a more accurate measurement. You can push it back $\frac{7}{8}$ " past the seal, hold tightly up along lower edge of track, and right up to the corner of the Mini Drip Edge before marking off. Then use a measuring tape to measure where you marked it off.

- 4) Trim rubber seal side of drip edge (side pointing to RV). See if supplied template fits nicely into the area up against & past the bulb/ wiper seal (holding it up to the lower track). If not, you can use the supplied card stock paper to create your own template. "You're trying to see what exact cut-out is needed to trace on to the end of the Drip Edge, so you can cut it out."

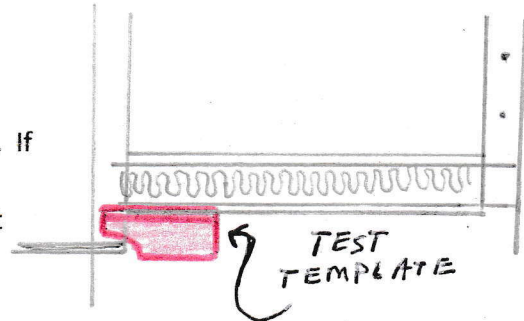

- 5) Once you have a template that works, place this directly Over your Drip Edge, and trace the small notch from your template. Cut out the traced notch on your Drip Edge. Note: you will flip over the template to use for the opposite side.

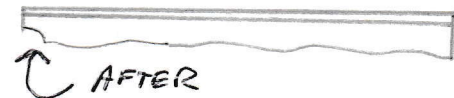
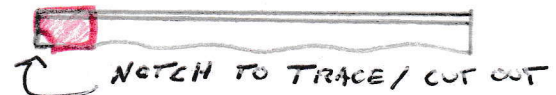

- 6) Apply the Hook portion of the Velcro tape to the lower track. First wipe down & clean entire lower track with rubbing alcohol (including the Installed Mini Drip Edge), let dry. Start installing the tape about $\frac{3}{4}$ " in past the bulb seal / rubber seal & work your way down slowly to the end over the top section of the Mini Drip Edge, (pushing in & attaching close to the upper section of the lower track. You don't want the Velcro tape wrapping around the lower track facing the ground.

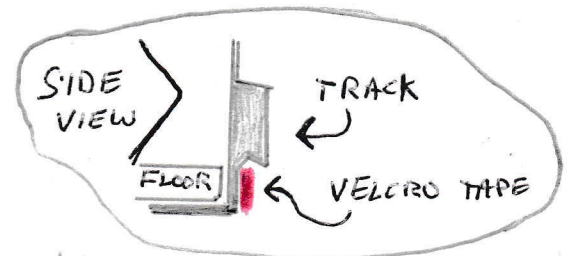
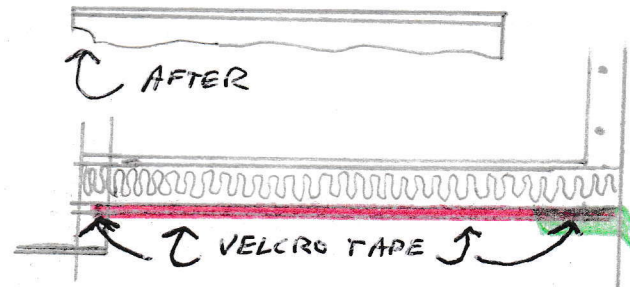

- 7) You can now line up the main Drip Edge to the installed Velcro starting with pushing in the small cut out section first (past bulb/ wiper seal), and working way to the Mini Drip Edge. Take your time lining it up as you don't want to pull it off and re-set it the first time. **Let this stay on for 72 hours to allow the adhesive in the Velcro tape to fully bond to the lower track. Pulling off sooner, could result in the Velcro tape failing.**

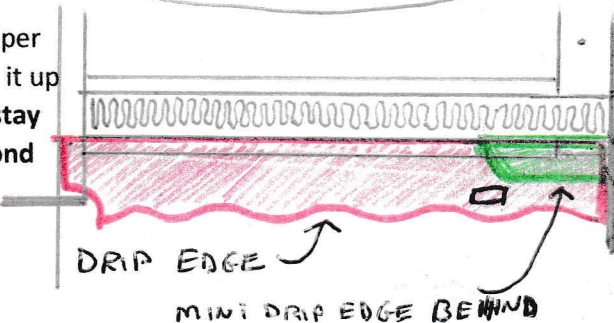

- 8) Draw a small chart on paper & number the back sides of the Drip Edges (with permanent marker), so you know what slides & what sides they go to, for making future placements simple. **Remember to remove the Drip Edges before bringing your slides in!!** To remove Drip Edge, simply start with either side, and pull forward towards you a little bit at a time, working your way down. It will separate/ tear off nicely.